



CONTROL POINT DETAILS	Station Number PSM 0419
Coordinate Information	
Geodetic	Grid
WGS 84	UTM Zone 43
Lat: 2:46:45.95334N	E 324793.521m
Long: 73:25:25.74700E	N: 307330.133m
Ellp Height: -97.2372	Orth Height: +0.905
Island Name: M.Kolhufushi	Date: 29 Apr 2021

Monument description & method of survey:

- Established to Type A monument standard. Monument labeled with S/S plate fixed to concrete by four bolts stating point ID.
- 75mm below surface.
- GNSS static survey post processing.
- Vertical control, PSM elevation reduced to MSL with reference to Tide data provided by Meteorology for Hulhule' tide station.

General site condition & access:

- Located Northern corner of the harbor Q wall.
- Easy access.

Owner: M.Kolhufushi Island Council

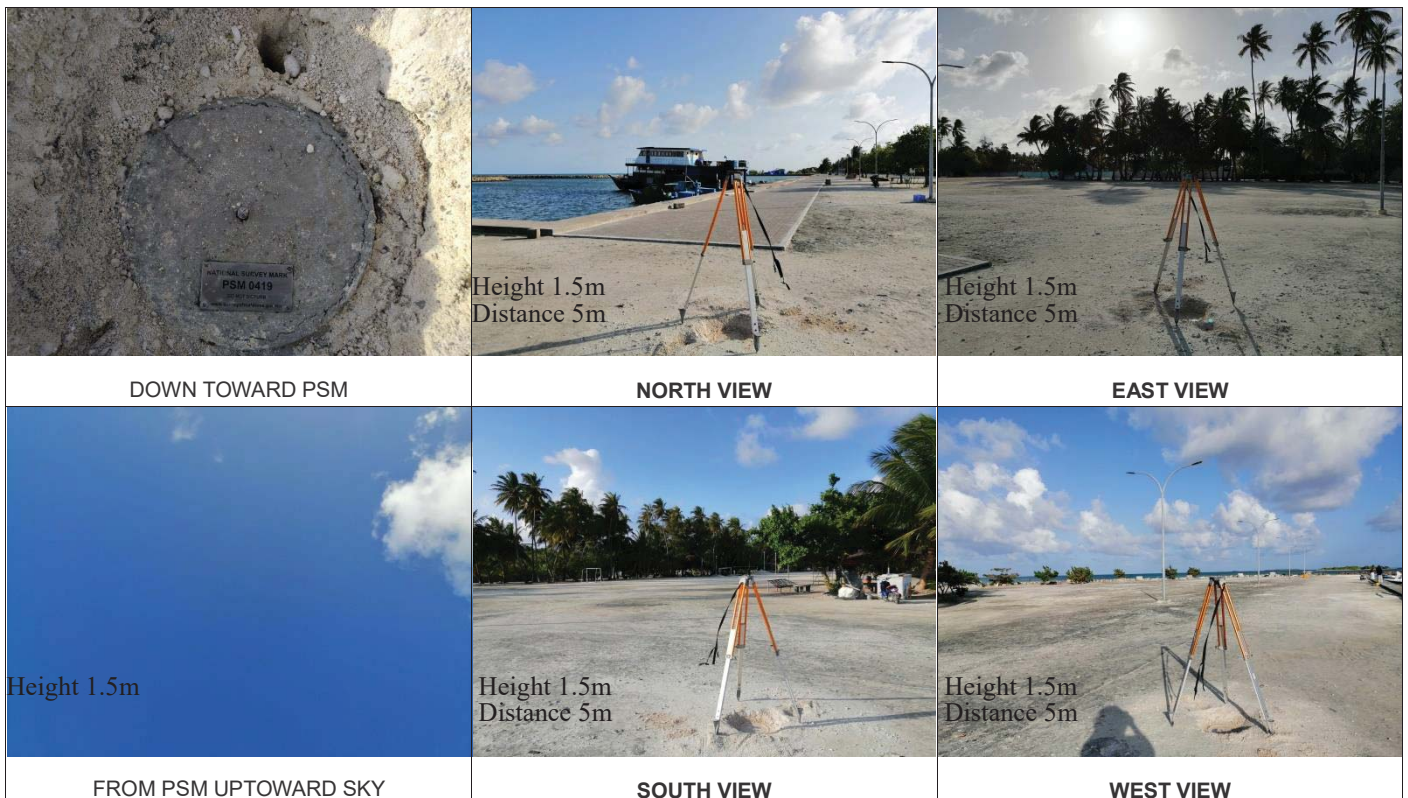

SITE INFORMATION

Station Number

P S M 0 4 1 9

Station Horizon Mask

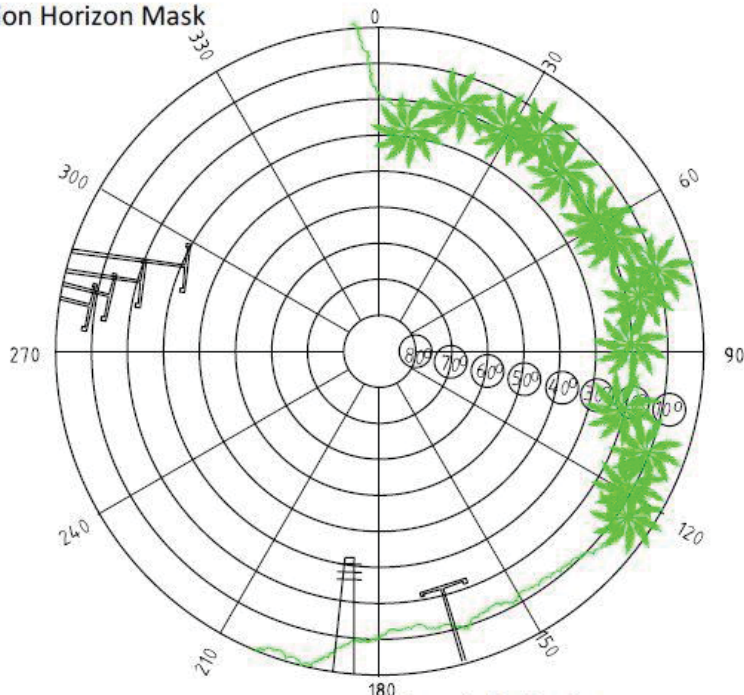

Height above Marker that horizon was mapped from 1.5 m

Magnetic Declination _____
 Declination applied to this figure?
 Yes No

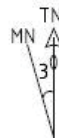

Locality

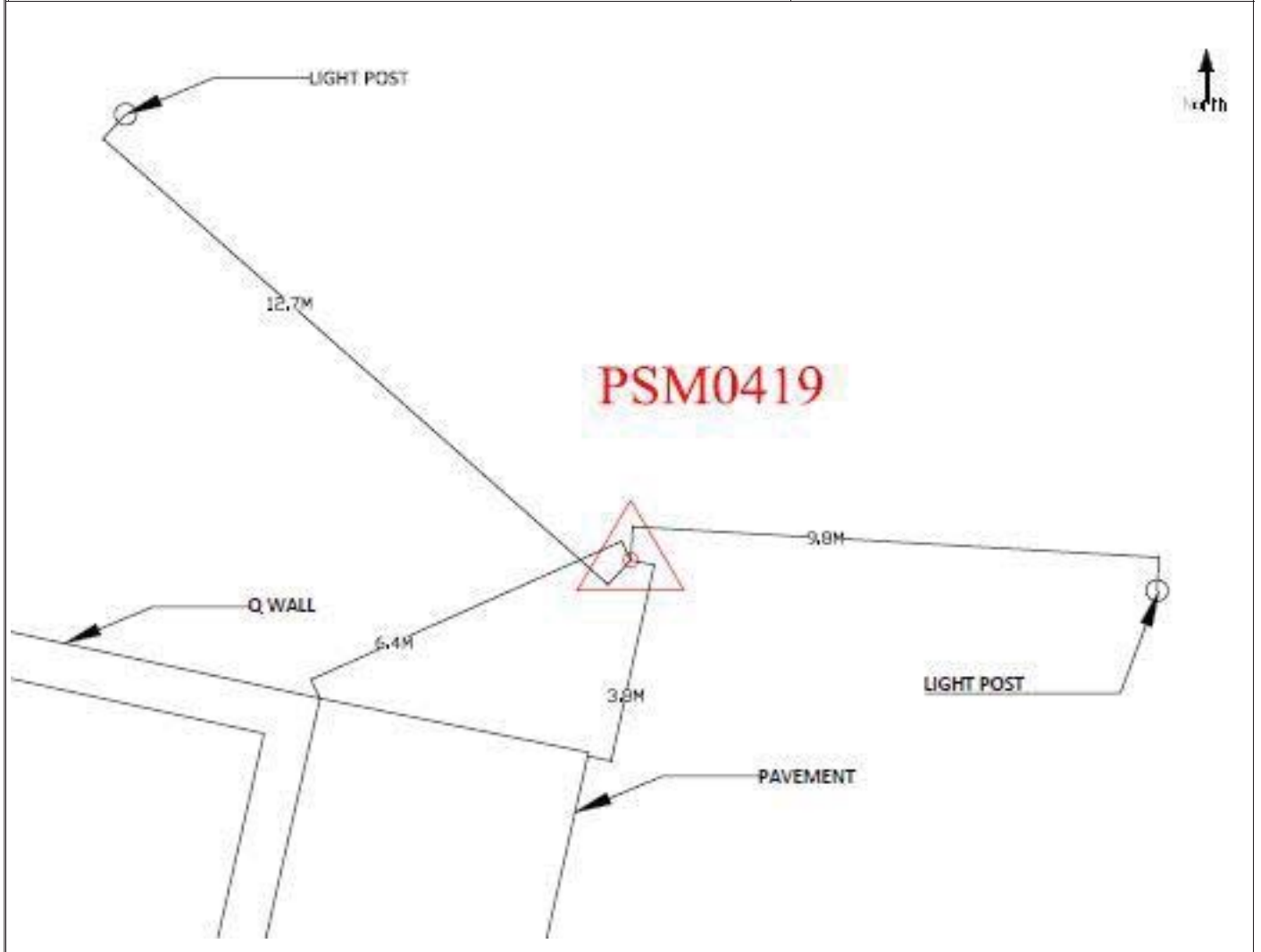

Sketched by: Ali Mubeen

Scale: Not to scale

Date: 29/4/2021



CONTROL POINT DETAILS	Station Number PSM 0420
Coordinate Information	
Geodetic	Grid
WGS 84	UTM Zone 43
Lat: 2:46:39.27255N	E 324748.481m
Long: 73:25:24.29755E	N: 307124.991m
Ellp Height:-97.2149	Orth Height: +0.927m
Island Name: M.Kolhufushi	Date: 29 Apr 2021

Monument description & method of survey:

- Established to Type A monument standard. Monument labeled with S/S plate fixed to concrete by four bolts stating point ID.
- 75mm below surface.
- GNSS static survey post processing.
- PSM elevation relative to the reduce elevation of PSM0419.

General site condition & access:

- Located Southern corner of the harbor Quay wall.
- Easy access.

Owner: M.Kolhufushi Island Council



SITE INFORMATION

Station Number

P S M 0 4 2 0

Station Horizon Mask

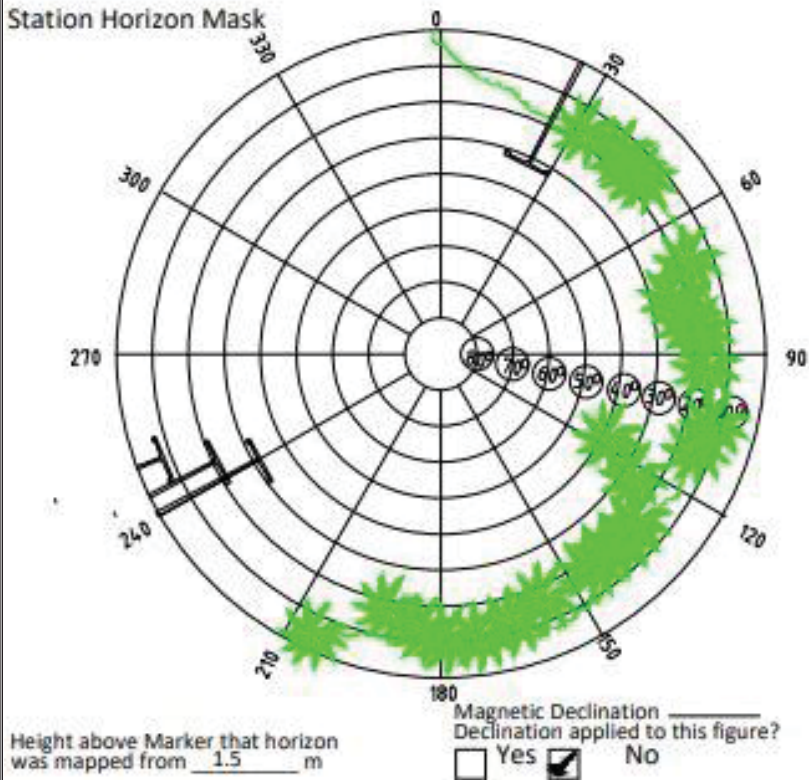

Locality

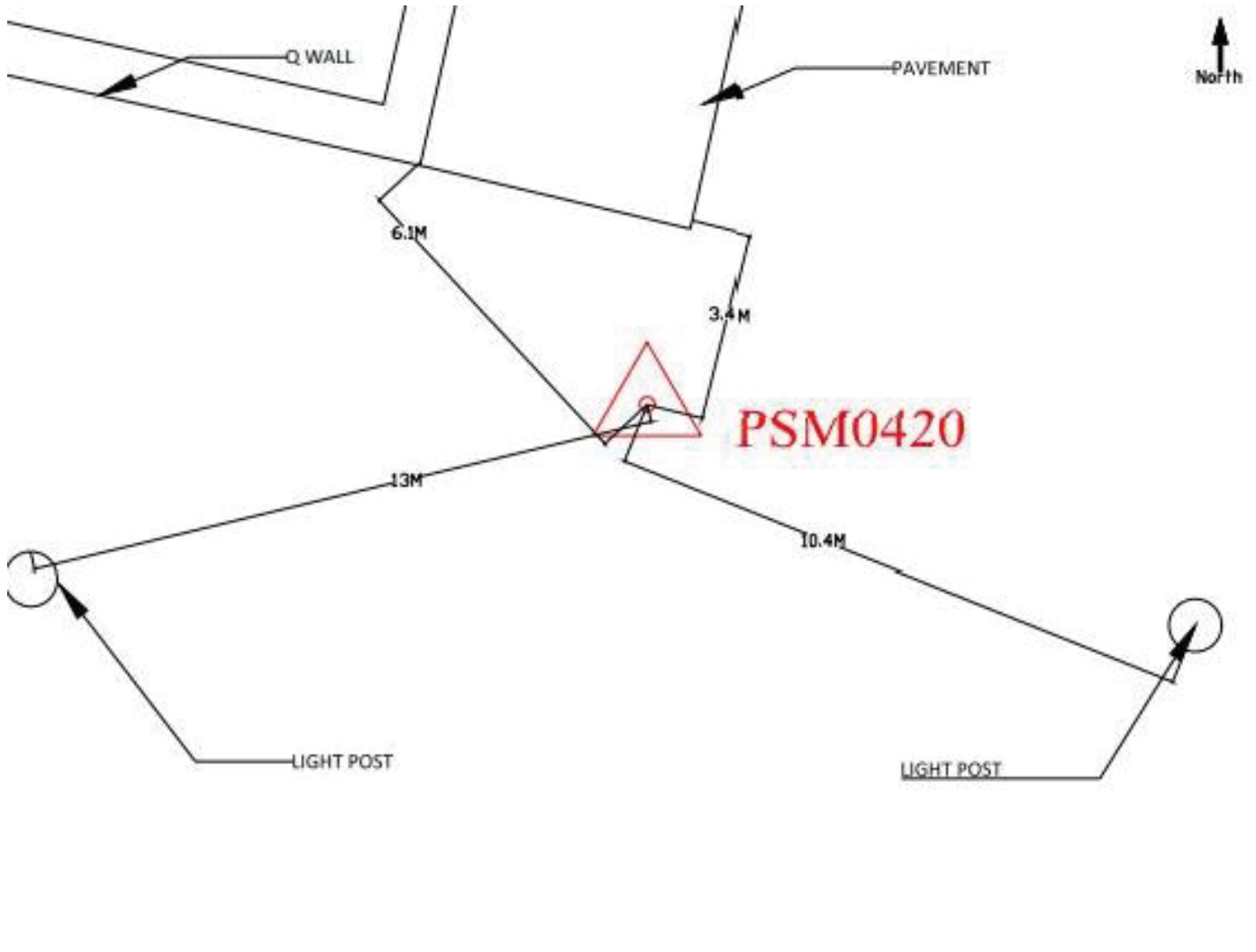

Sketched by: Ali Mubeen

Scale: Not to scale

Date: 29/04/2021



CONTROL POINT DETAILS	Station Number PSM 0421
Coordinate Information	
Geodetic	Grid
WGS 84	UTM Zone 43
Lat: 2:46:42.25027N	E 324988.692m
Long: 73:25:32.07113E	N: 307216.132m
Ellp Height: -97.3430	Orth Height: +0.799m
Island Name: M.Kolhufushi	Date: 29 Apr 2021

Monument description & method of survey:

- Established to Type A monument standard. Monument labeled with S/S plate fixed to concrete by four bolts stating point ID.
- 75mm below surface.
- GNSS static survey post processing.
- PSM elevation relative to the reduced elevation of PSM0419.

General site condition & access:

- Located in front of the football stadium gate.
- Easy access.

Owner: M.Kolhufushi Island Council

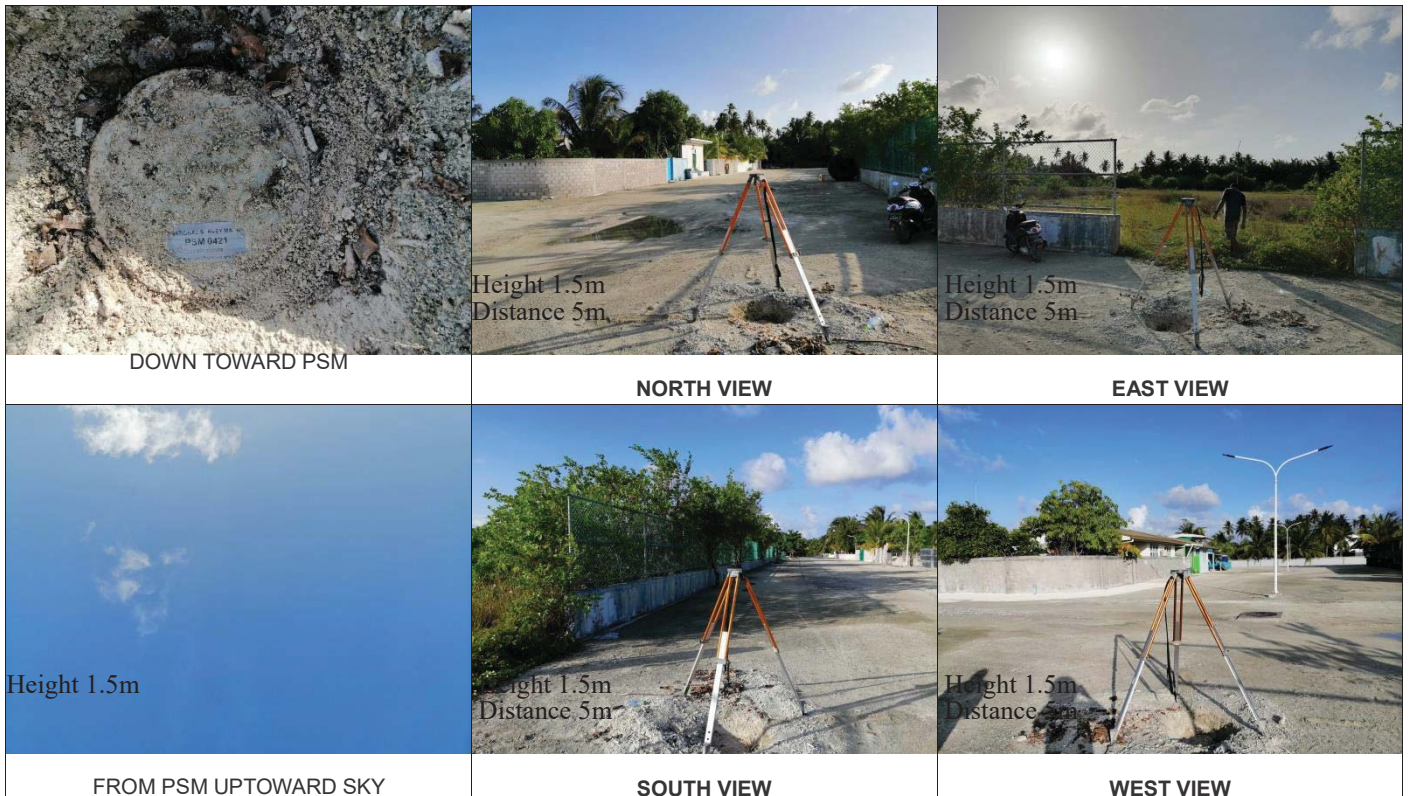

SITE INFORMATION

Station Number

P S M 0 4 2 1

Station Horizon Mask

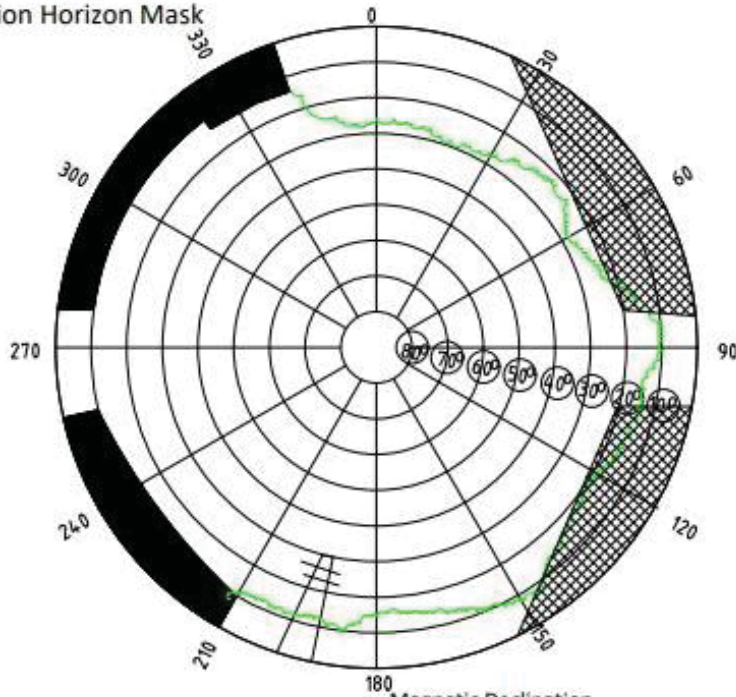

Height above Marker that horizon was mapped from 1.5 m

Magnetic Declination Declination applied to this figure?
 Yes No

Locality

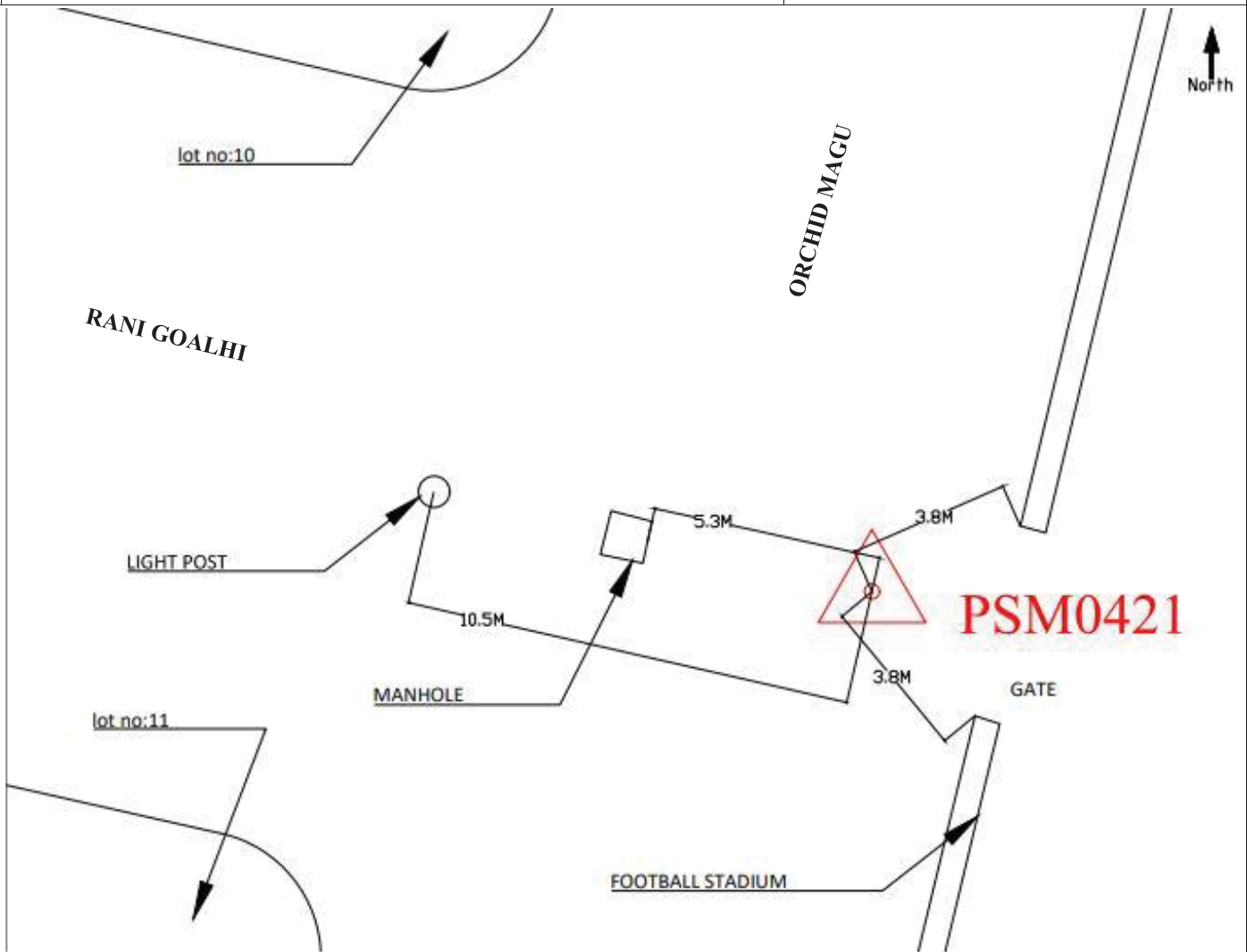

Sketched by: Ali Mubeen

Scale: Not to scale

Date: 29/04/2021