

MALDIVES LAND SURVEY AUTHORITY

MINISTRY OF HOUSING AND INFRASTRUCTURE

Office (PABX): +(960) 3004300, Fax: +(960) 3004254

Email: survey@housing.gov.mv

Web: www.surveyofmaldives.gov.mv,

Ameenee Magu, Maafannu, Male', 20392, Maldives.



CONTROLPOINT DETAILS	Station Number	PSM 0488
Coordinate Information		
Geodetic	Grid	
WGS 84	UTM Zone 43	
Lat: 3:32:03.57366N	E:	269858.949m
Long: 72:55:41.94058E	N:	390910.766m
Ellp Height:	Orth Height: +1.183m	
Island Name: ADH.DHIGURAH	Date: 22 AUG 2021	

Monument description & method of survey:

- Established to Type A monument standard. -Stainless steel plate fixed to concrete by Four bolts - Horizontal coordinates fixed by GNSS Static survey.
- Stainless steel plate fixed to concrete by Four bolts
- Horizontal coordinates fixed by GNSS Static survey.
- Below 200mm
- Reduced level of PSM 0489 was transferred to PSM 0488 by using level difference obtained from GNSS static survey

General site condition & access:

- Easily accessible area with wide angle of sky visibility
- Located in the north western end of the foot ball field

Owner: Adh.Dhigurah Council- GOVT of Maldives

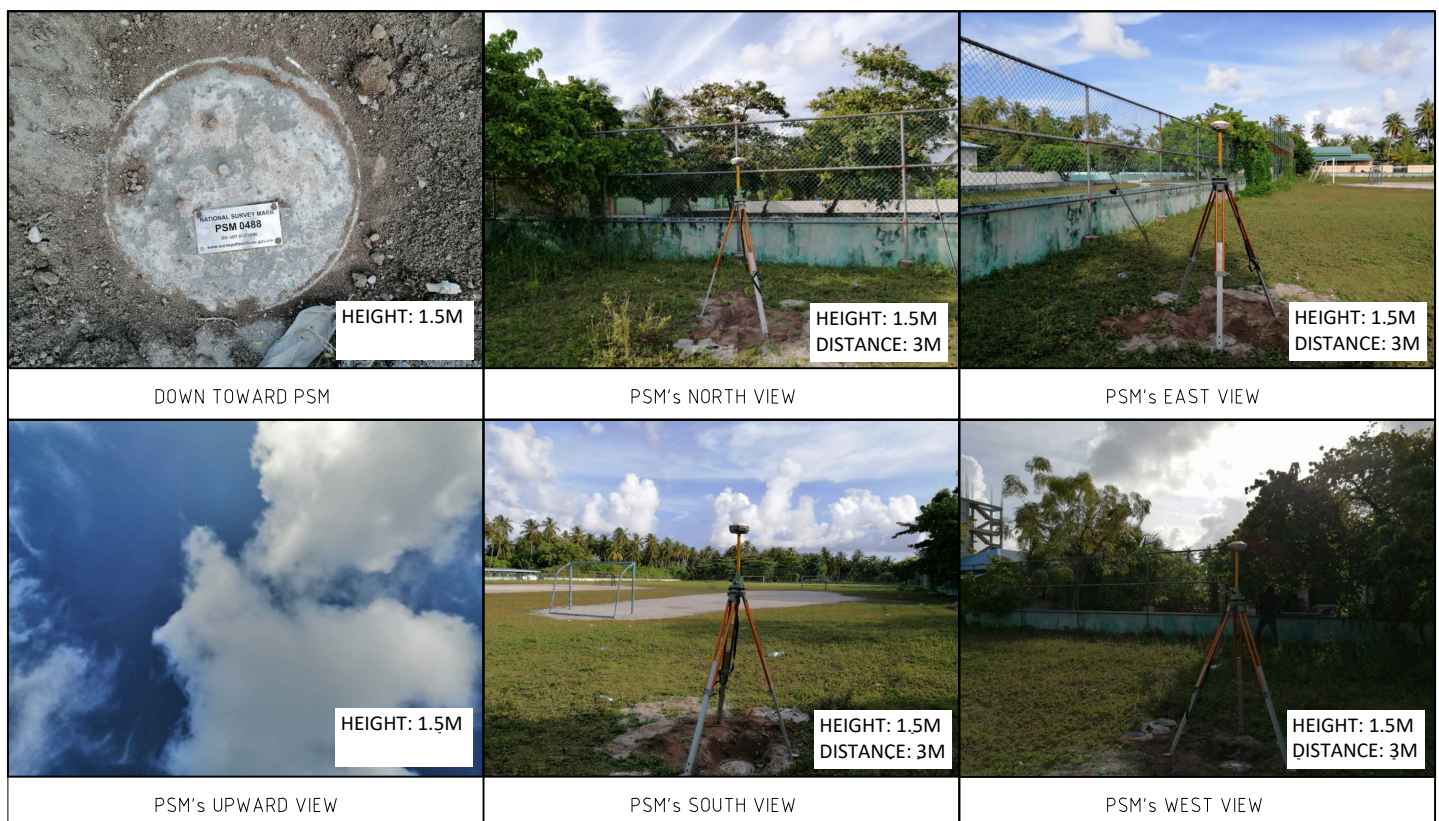

SITE INFORMATION

Station Number

P	S	M	0	4	8	8
---	---	---	---	---	---	---

Station Horizon Mask

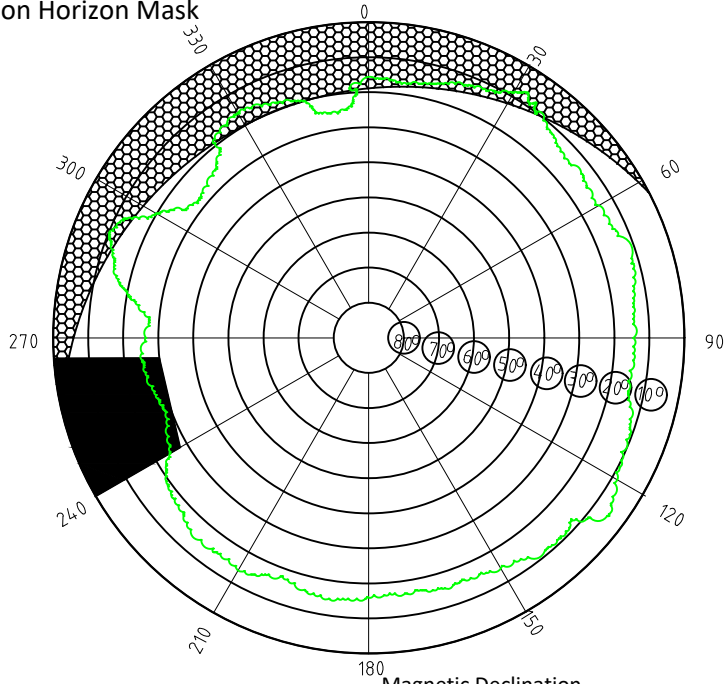

Height above Marker that horizon was mapped from 1.5 m

Magnetic Declination Declination applied to this figure?
 Yes No



Locality

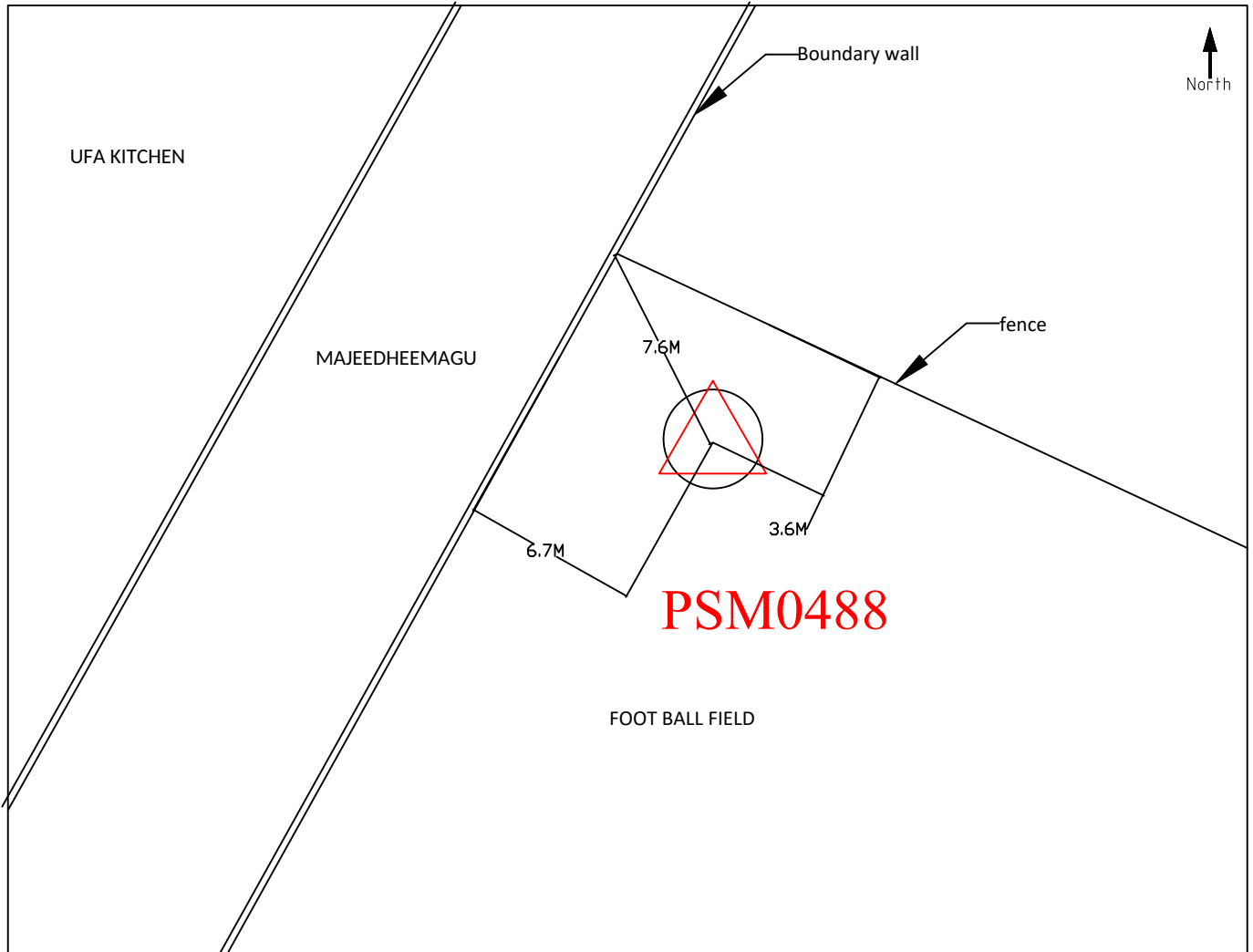
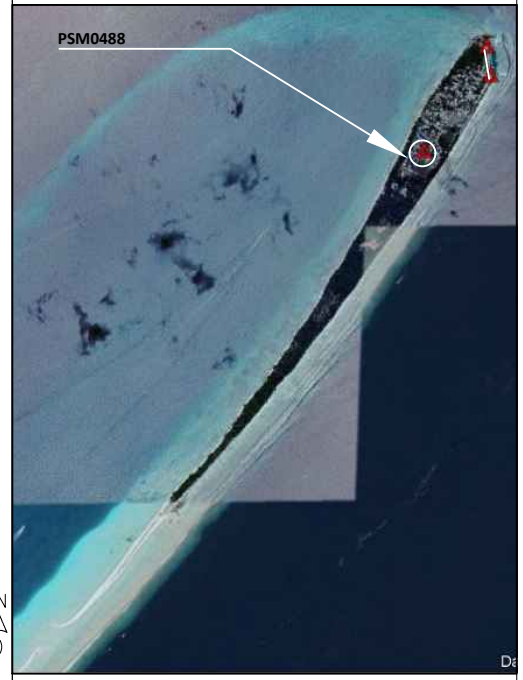

Sketched by: MUBEEN

Scale: Not to Scale

Date: 22 AUG 2021

MALDIVES LAND SURVEY AUTHORITY

MINISTRY OF HOUSING AND INFRASTRUCTURE

Office (PABX): +(960) 3004300, Fax: +(960) 3004254

Email: survey@housing.gov.mv

Web: www.surveyofmaldives.gov.mv,

Ameenee Magu, Maafannu, Male', 20392, Maldives.



CONTROLPOINT DETAILS	Station Number	PSM 0489
Coordinate Information		
Geodetic	Grid	
WGS 84	UTM Zone 43	
Lat: 3:32:24.25142N	E:	270210.505m
Long: 72:55:53.28245E	N:	391545.289m
Ellp Height:	Orth Height:	+0.871
Island Name: ADH.DHIGURAH	Date:	22 AUG 2021

Monument description & method of survey:

- Established to Type A monument standard. -Stainless steel plate fixed to concrete by Four bolts - Horizontal coordinates fixed by GNSS Static survey.
- Stainless steel plate fixed to concrete by Four bolts
- Horizontal coordinates fixed by GNSS Static survey.
- Below 200mm
- Elevation reduced relative to Local MSL by reference to tide prediction data MET (Hulhule')

General site condition & access:

- Easily accessible area with wide angle of sky visibility
- Located near the Northern end of the harbour

Owner: Adh.Dhigurah Council- GOVT of Maldives

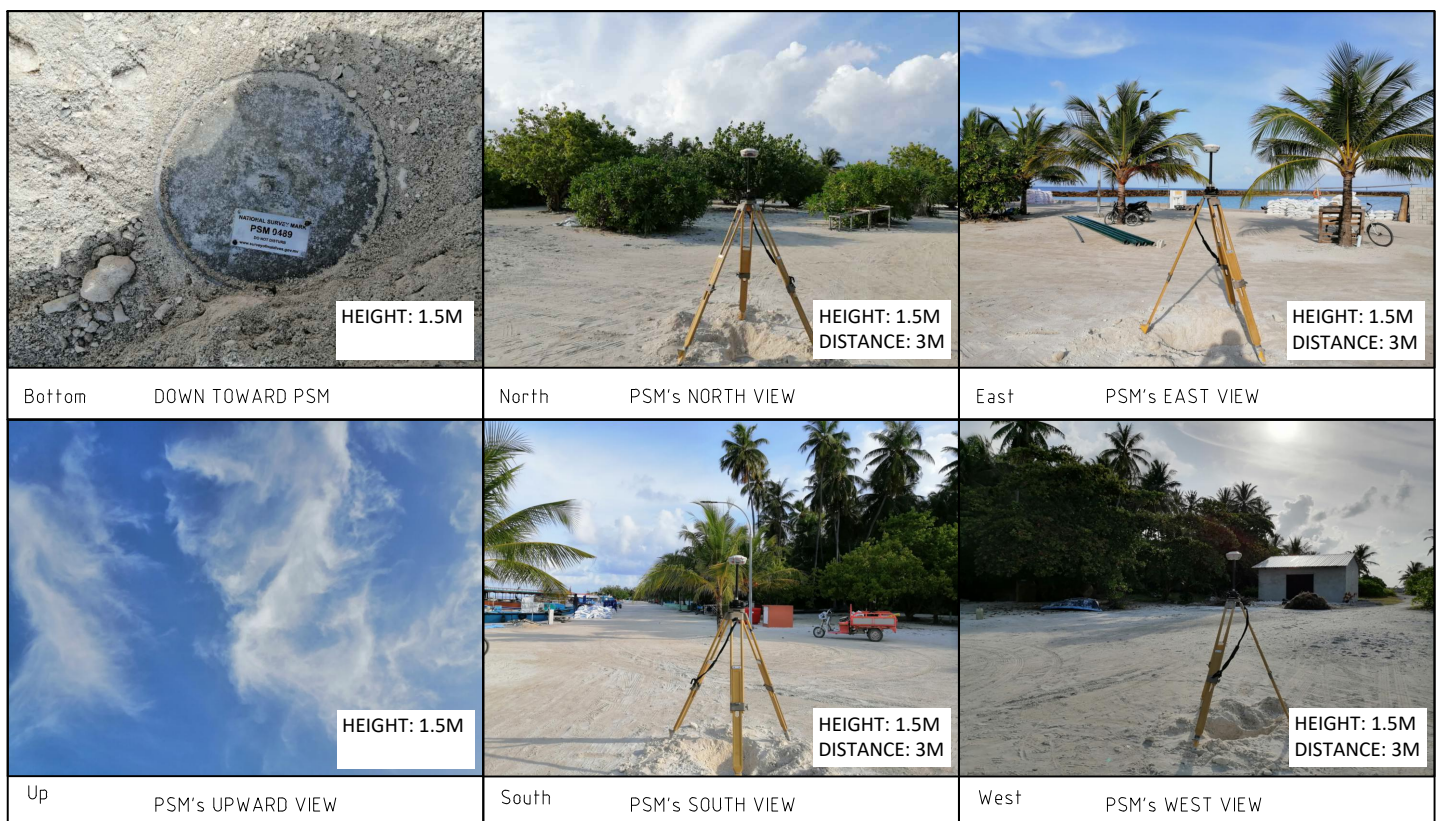

SITE INFORMATION

Station Number

P	S	M	0	4	8	9
---	---	---	---	---	---	---

Station Horizon Mask

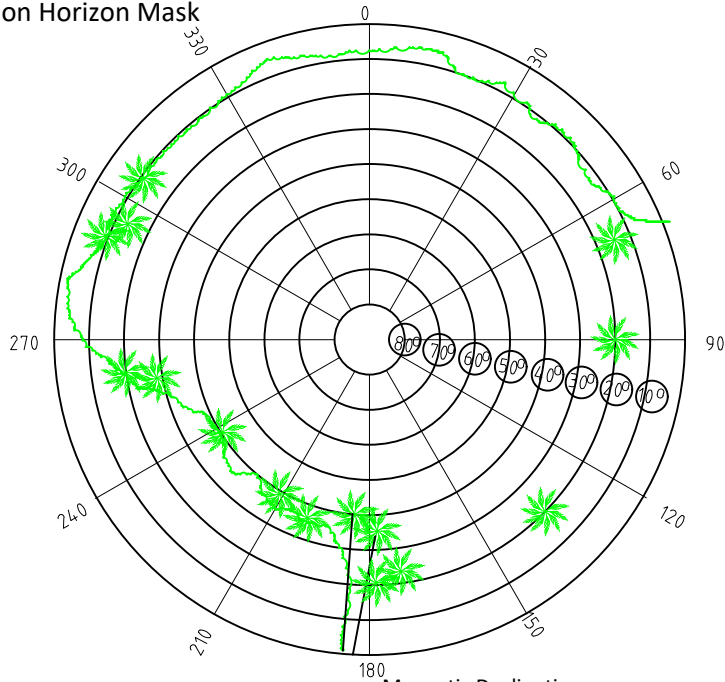

Locality



Height above Marker that horizon was mapped from 1.5 m

Magnetic Declination _____
 Declination applied to this figure?
 Yes No



PSM0489

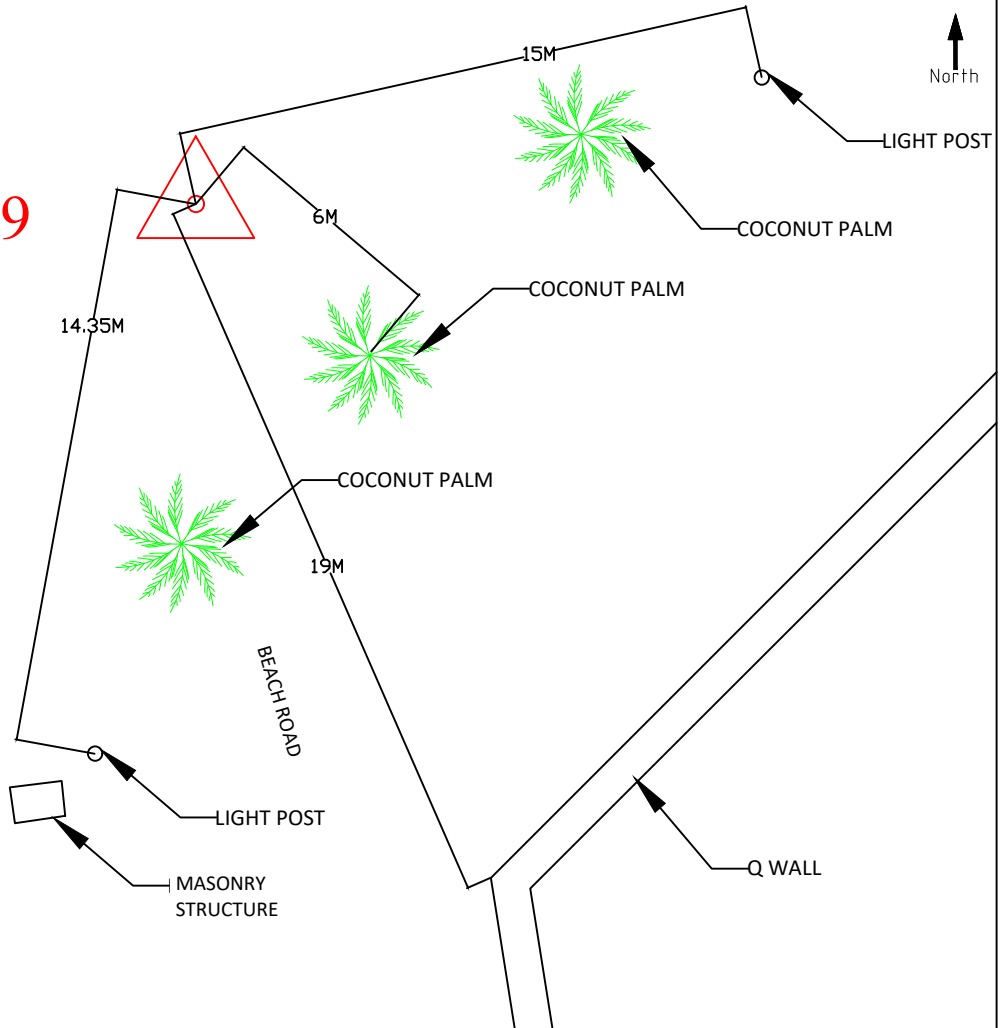

Sketched by: MUBEEN

Scale: Not to Scale

Date: 22 AUG 2021

MALDIVES LAND SURVEY AUTHORITY

MINISTRY OF HOUSING AND INFRASTRUCTURE

Office (PABX): +(960) 3004300, Fax: +(960) 3004254

Email: survey@housing.gov.mv

Web: www.surveyofmaldives.gov.mv,

Ameenee Magu, Maafannu, Male', 20392, Maldives.



CONTROLPOINT DETAILS	Station Number	PSM 0490
Coordinate Information		
Geodetic	Grid	
WGS 84	UTM Zone 43	
Lat: 3:32:18.47859N	E:	270240.705m
Long: 72:55:54.27351E	N:	391367.857m
Ellp Height:	Orth Height:	+0.866m
Island Name: ADH.DHIGURAH	Date:	22 AUG 2021

Monument description & method of survey:

- Established to Type A monument standard. -Stainless steel plate fixed to concrete by Four bolts - Horizontal coordinates fixed by GNSS Static survey.
- Stainless steel plate fixed to concrete by Four bolts
- Horizontal coordinates fixed by GNSS Static survey.
- Below 200mm
- Reduced level of PSM 0489 was transferred to PSM 0490 by using level difference obtained from GNSS static survey

General site condition & access:

- Easily accessible area with wide angle of sky visibility
- Located near the southern end of the harbour

Owner: Adh.Dhigurah Council- GOVT of Maldives

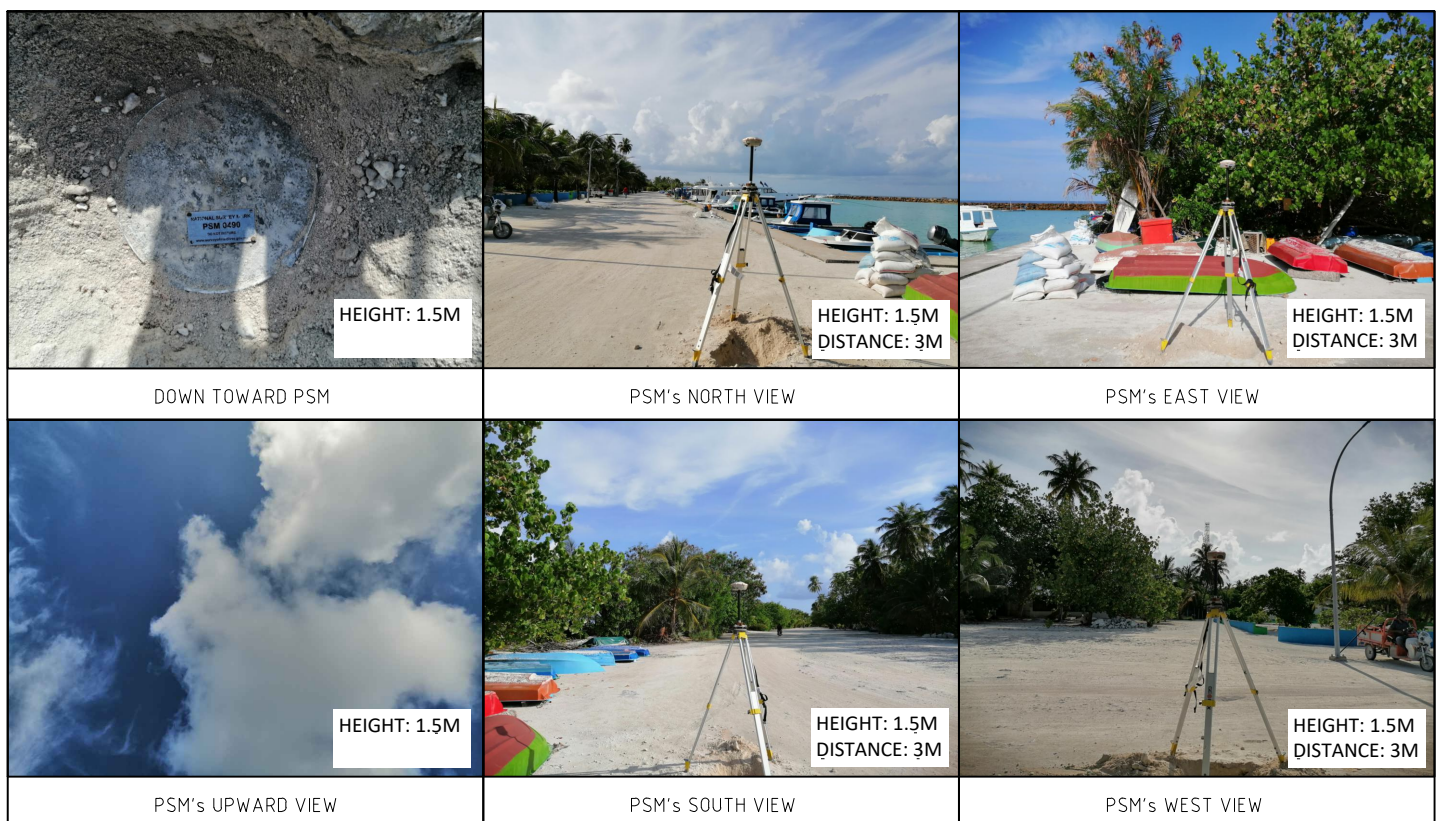

SITE INFORMATION

Station Number

P	S	M	0	4	9	0
---	---	---	---	---	---	---

Station Horizon Mask

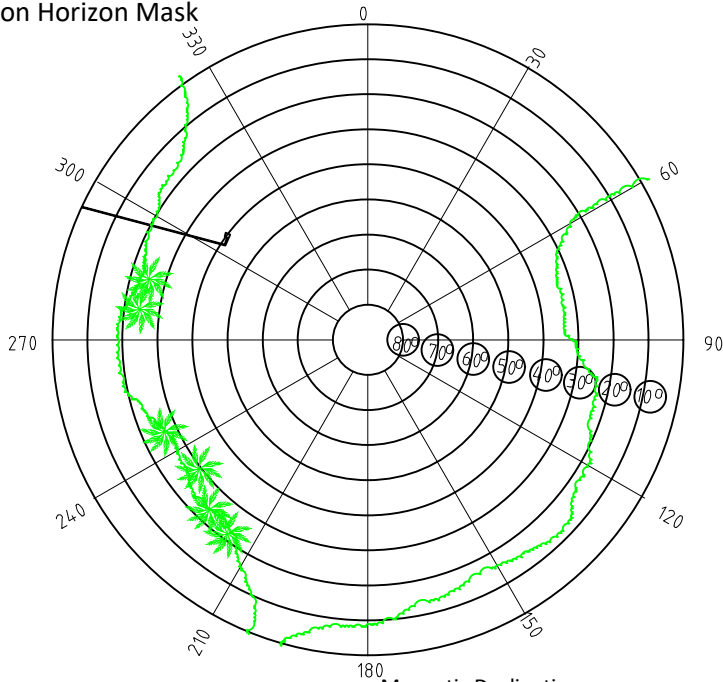

Locality



Height above Marker that horizon was mapped from 1.5 m

Magnetic Declination Declination applied to this figure?
 Yes No

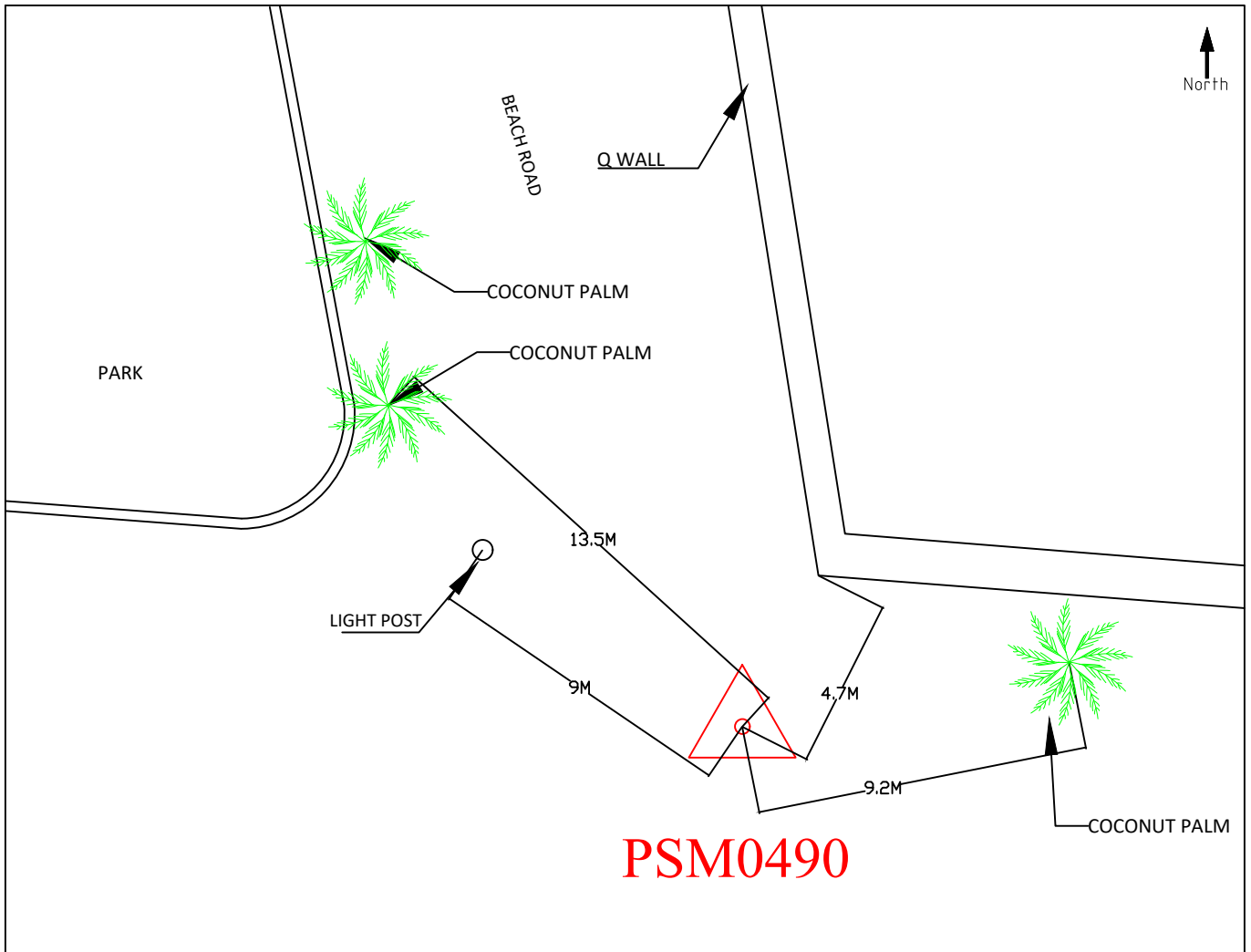

PSM0490

Sketched by: MUBEEN

Scale: Not to Scale

Date: 22 AUG 2021