

MALDIVES LAND SURVEY AUTHORITY

MINISTRY OF HOUSING AND INFRASTRUCTURE
 Office (PABX): +(960) 3004300, Fax: +(960) 3004254
 Email: survey@housing.gov.mv
 Web: www.surveyofmaldives.gov.mv,
 Ameenee Magu, Maafannu, Male', 20392, Maldives.



CONTROL POINT DETAILS	Station Number	PSM 5861
Coordinate Information		
Geodetic	Grid	
WGS 84	UTM Zone 43	
Lat: 0°27'41.68547"N	E: 294706.293m	
Long: 73°09'19.21928"E	N: 51045.022m	
Ellp Height: -80.491	Orth Height: +1.228	
Island Name: GDh.Konotta, Maldives	Date: 7th August 2022	

Monument description & method of survey:

- Monument Type A as in Technical Brief , However instead of PVC pipe , Wooden Box (0.3m x 0.3mx 1.0m) has been used.
- Stainless steel plate fixed to concrete by Four bolts
- Horizontal coordinates fixed by GNSS Static survey.
- Elevation reduced relative to ellipsoid height difference , reference to PSM 5862 which was corrected to Meanwater level by tide prediction table (Gan)
- PSM 5861 is at the ground Level

General site condition & access:

- Easily accessible area with wide angle of sky visibility
- Located at South West side of the island near swimming pool.
- Situated 0.4 m away from the middle of swimming pool .

Owner: O.K.M Private Limited

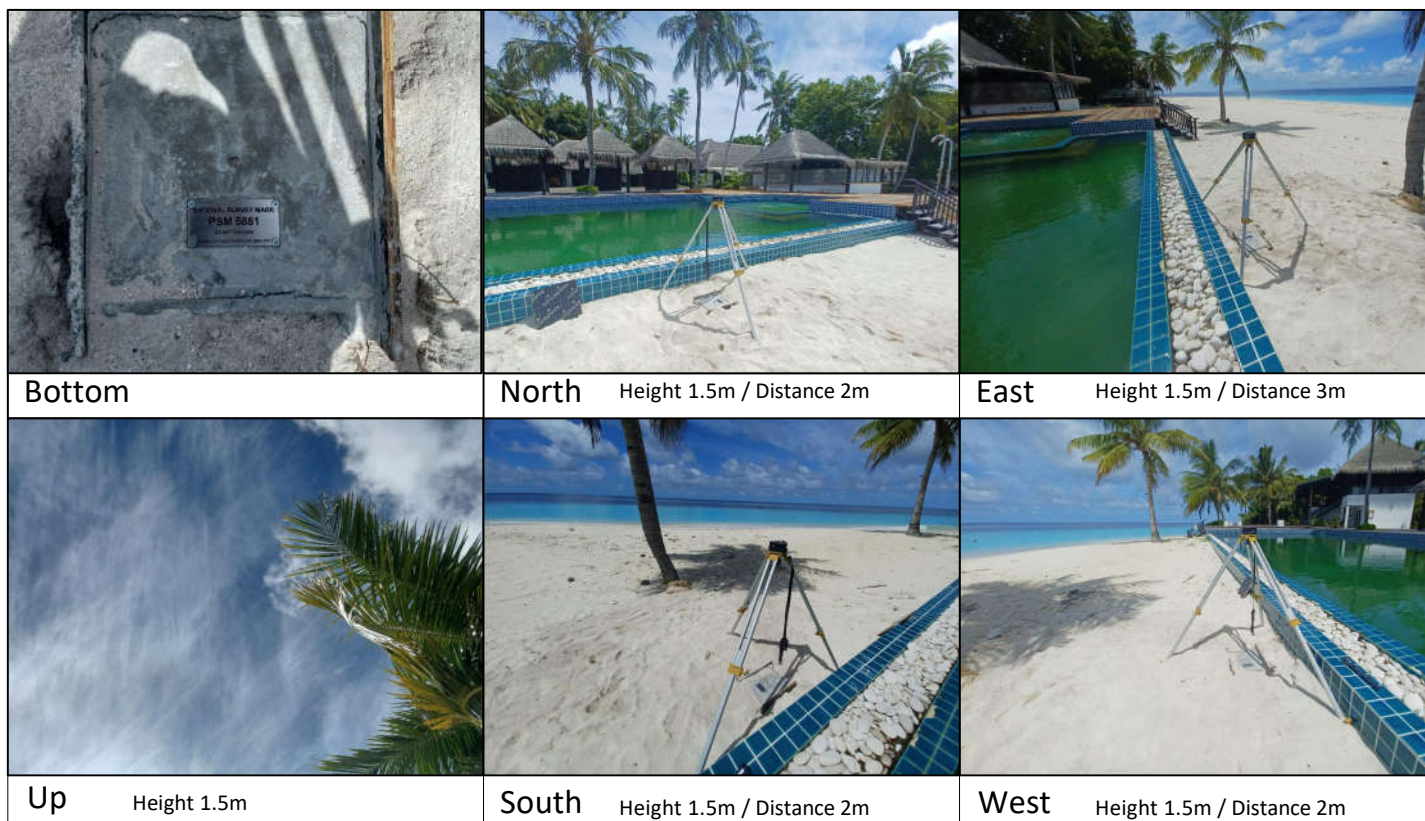

SITE INFORMATION

Station Number

P	S	M	5	8	6	1
---	---	---	---	---	---	---

Station Horizon Mask

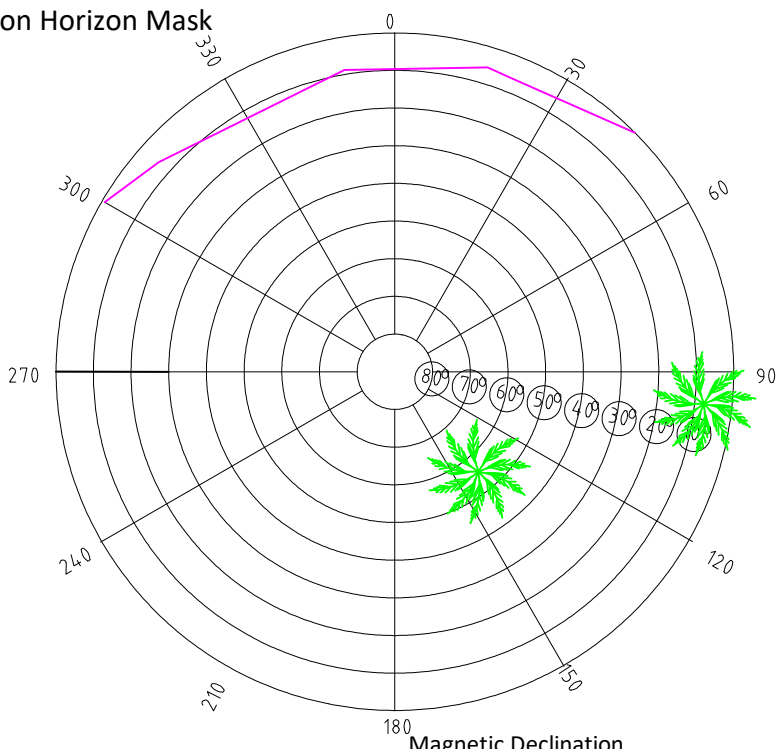

Height above Marker that horizon was mapped from 1.5 m

Magnetic Declination _____
 Declination applied to this figure?
 Yes No

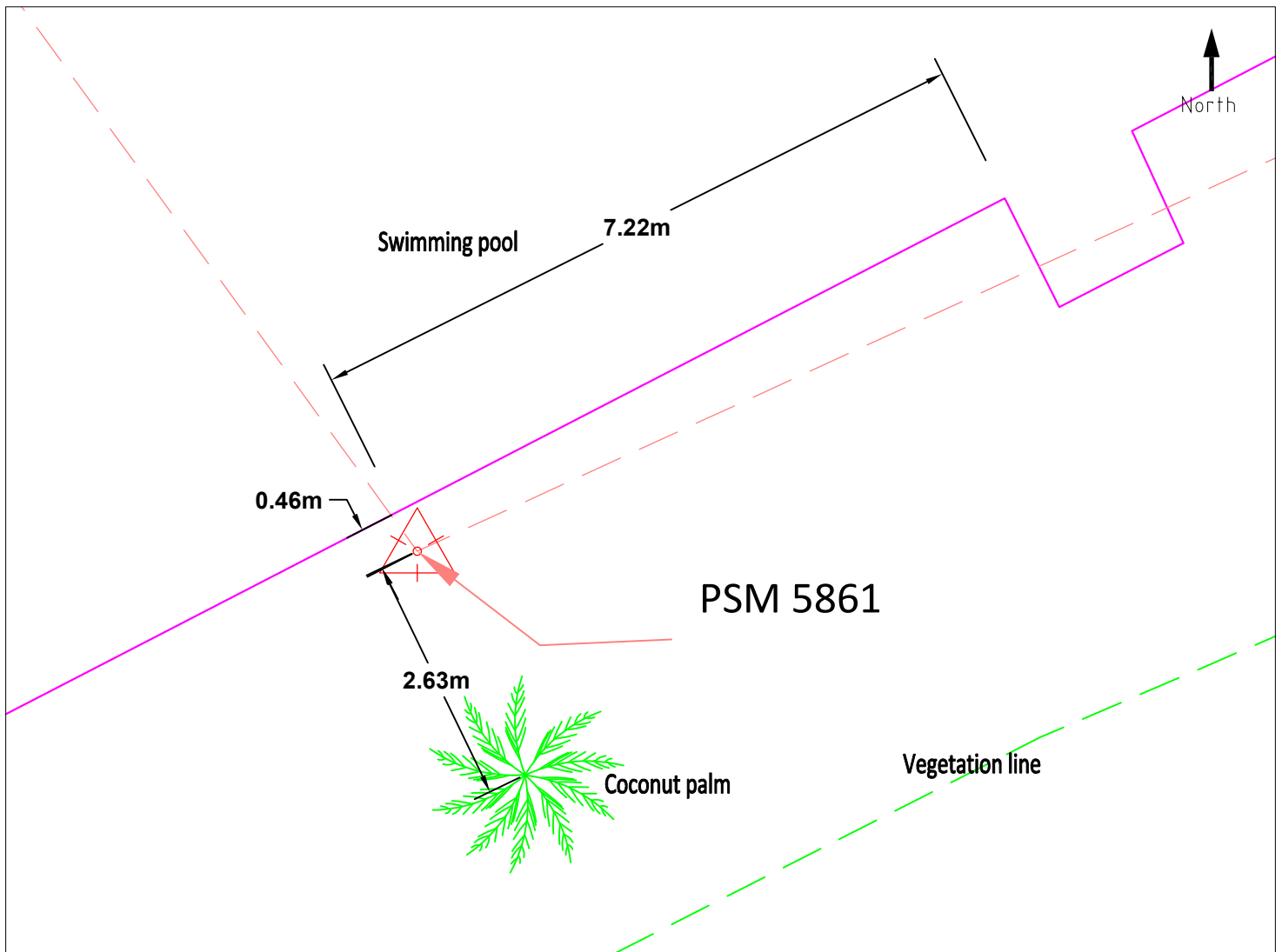
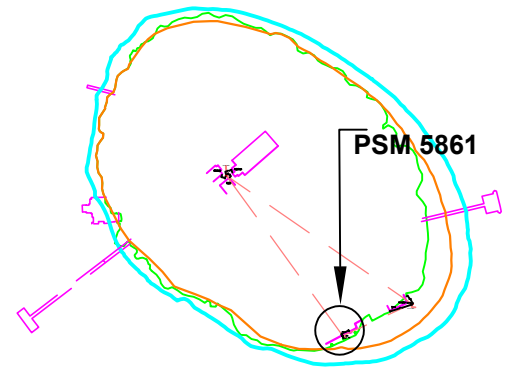

Sketched by: AHMED

Scale: Not to Scale

Date: 9th August 2022

MALDIVES LAND SURVEY AUTHORITY

MINISTRY OF HOUSING AND INFRASTRUCTURE
Office (PABX): +(960) 3004300, Fax: +(960) 3004254
Email: survey@housing.gov.mv
Web: www.surveyofmaldives.gov.mv,
Ameenee Magu, Maafannu, Male', 20392, Maldives.



CONTROL POINT DETAILS	Station Number	PSM 5862
Coordinate Information		
Geodetic	Grid	
WGS 84	UTM Zone 43	
Lat: 0°27'42.65961"N	E: 294771.563m	
Long: 73°09'21.32962"E	N: 51074.930m	
Ellp Height: -80.773	Orth Height: + 0.946	
Island Name: GDh.Konotta, Maldives	Date: 7th August 2022	

Monument description & method of survey:

- Monument Type A as in Technical Brief. However instead of PVC pipe, Wooden Box (0.3m x 0.3m x 1.0m) has been used.
- Stainless steel plate fixed to concrete by Four bolts
- Horizontal coordinates fixed by GNSS Static survey.
- Vertical height corrected using tide prediction data (Gan)
- PSM 5862 is 0.175m above the ground Level

General site condition & access:

- Easily accessible area with wide angle of sky visibility
- Located at the South east side of the island
- Situated 4.8 m away from South east corner deck of restaurant

Owner: O.K.M Private Limited

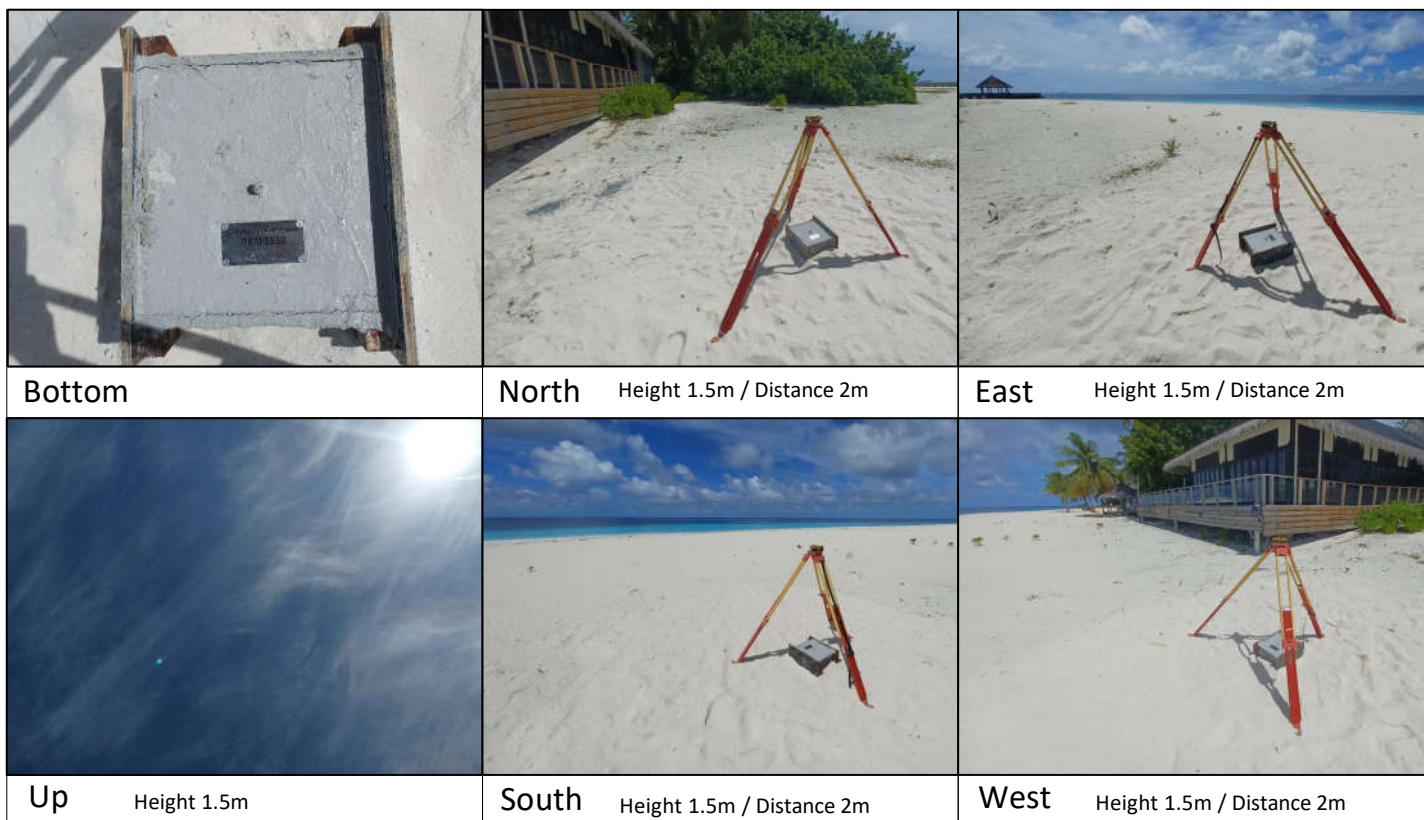

SITE INFORMATION

Station Number

P	S	M	5	8	6	2
---	---	---	---	---	---	---

Station Horizon Mask

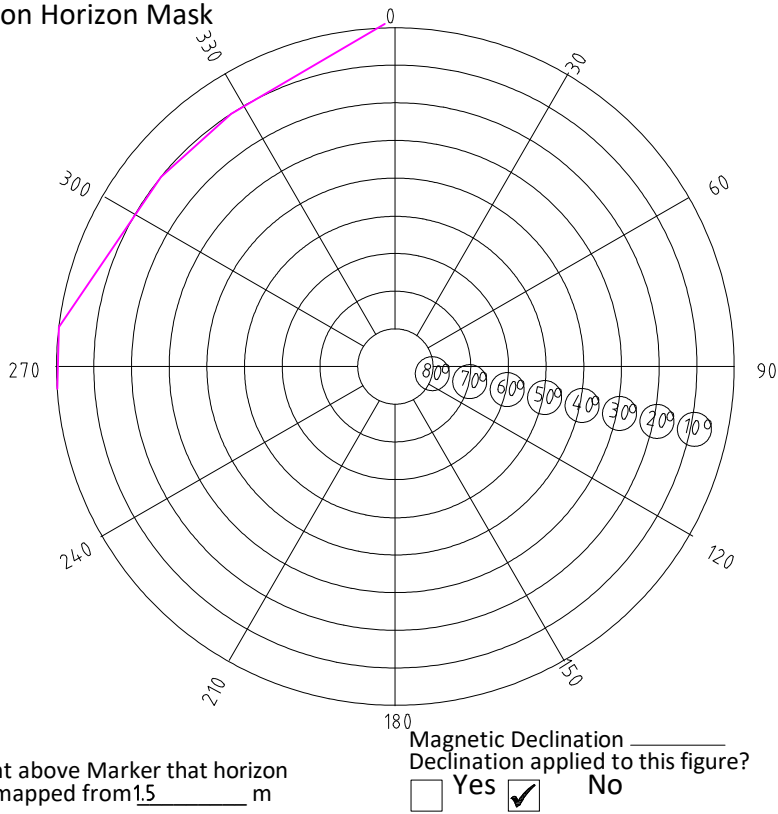

Height above Marker that horizon was mapped from 1.5 m

Magnetic Declination _____
 Declination applied to this figure?
 Yes No

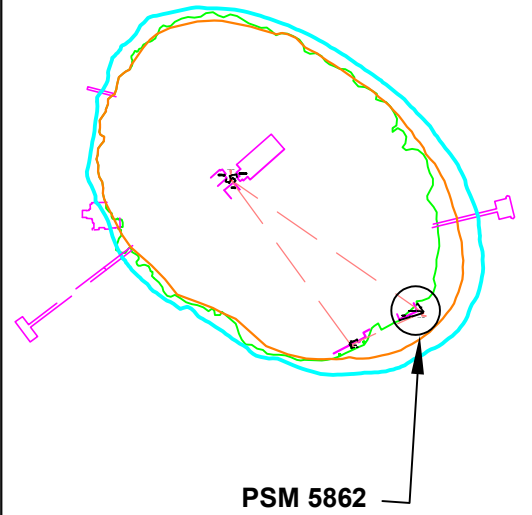

PSM 5862

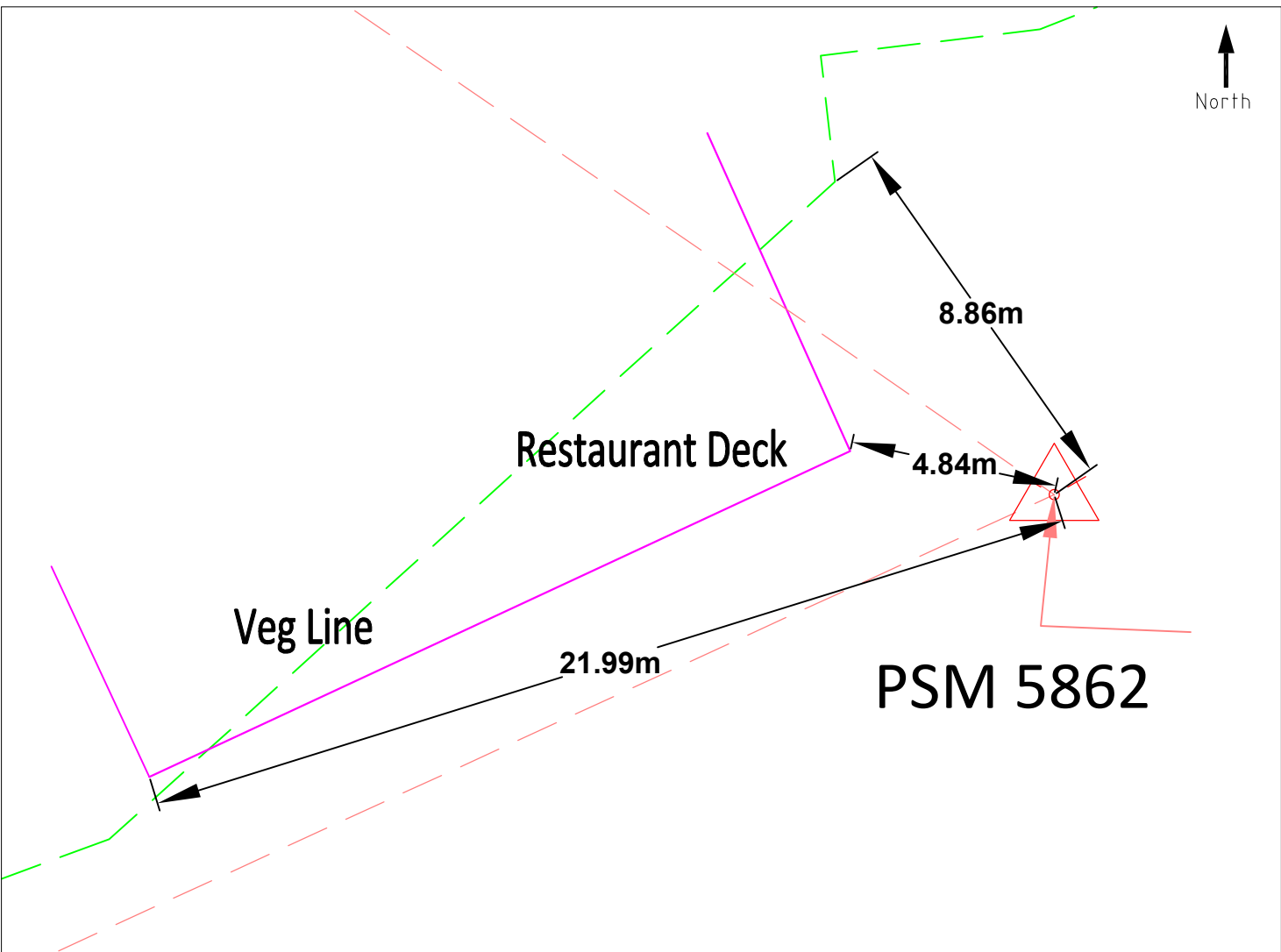

Sketched by: AHMED

Scale: Not to Scale

Date: 9th August 2022

MALDIVES LAND SURVEY AUTHORITY

MINISTRY OF HOUSING AND INFRASTRUCTURE
Office (PABX): +(960) 3004300, Fax: +(960) 3004254
Email: survey@housing.gov.mv
Web: www.surveyofmaldives.gov.mv,
Ameenee Magu, Maafannu, Male', 20392, Maldives.



CONTROL POINT DETAILS	Station Number	PSM 5863
Coordinate Information		
Geodetic	Grid	
WGS 84	UTM Zone 43	
Lat: 0°27'46.60113"N	E: 294596.603m	
Long: 73°09'15.67100"E	N: 51196.054m	
Ellp Height: -79.972	Orth Height: +1.747	
Island Name: GDh.Konotta, Maldives	Date: 7th August 2022	

Monument description & method of survey:

- Monument Type A as in Technical Brief However instead of PVC pipe , Wooden Box (0.3m x 0.3mx 1.0m) has been used.
- Stainless steel plate fixed to concrete by Four bolts
- Horizontal coordinates fixed by GNSS Static survey.
- Elevation reduced relative to ellipsoid height difference reference to PSM 5862 which was corrected to Meanwater level by tide prediction table.
- PSM0 5863 is 0.150m below the ground Level

General site condition & access:

- Easily accessible area with wide angle of sky visibility
- Located at the North side of the island.
- Located next to the service buildings of the island.
- Situated 3.6m away from the Laundry of the island

Owner: O.K.M Private Limited



SITE INFORMATION

Station Number

P	S	M	5	8	6	3
---	---	---	---	---	---	---

Station Horizon Mask

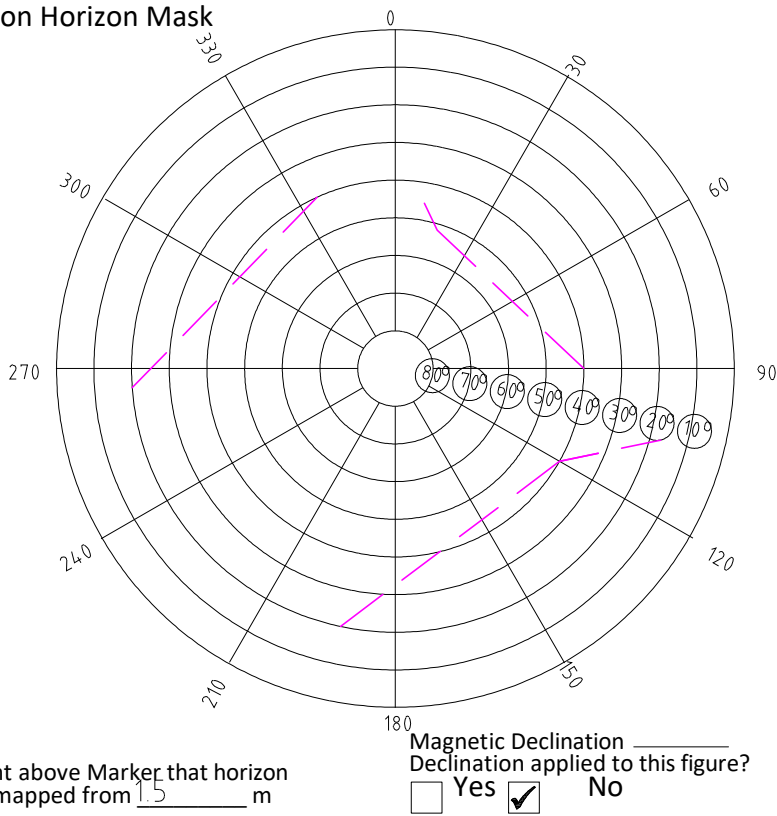

Height above Marker that horizon was mapped from 1.5 m

Magnetic Declination _____
 Declination applied to this figure?
 Yes No

PSM 5863

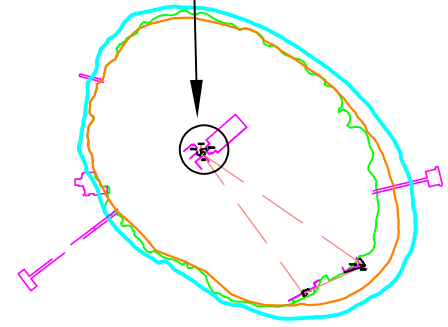

PSM 5863

Cold storage

R0 plant room

Laundry

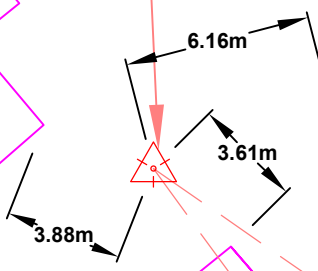

Sketched by: AHMED

Scale: Not to Scale

Date: 9th August 2022